



Inductive Transducer
Differential Inductor Type
WLG (calibrated to 80 mV/V)

MESSOTRON

Litz interface

Teflon® baided wire 250 mm long
 core channel continuous

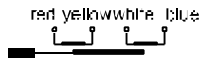

Example: WLG 100 0,5%

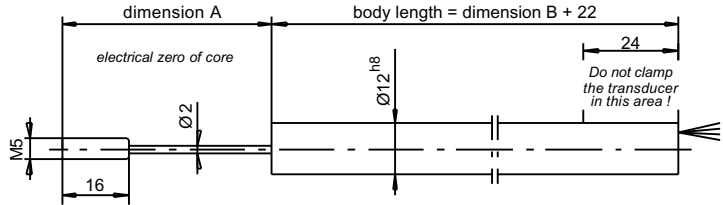

Axial wire interface

PE-cable 2,5 m long; special option:
 oil- and temperature resistant teflon-cable
 core channel non continuous

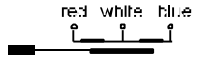

Example: WLG 100 K 0,25%

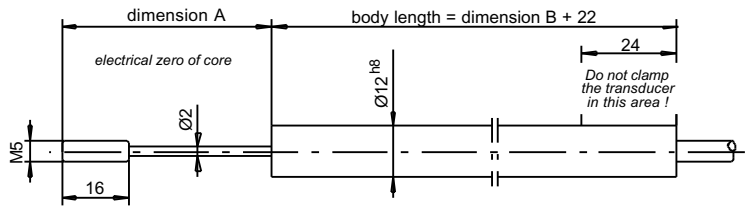

Radial wire interface

PE-cable 2,5 m long; special option:
 oil- and temperature resistant teflon-cable
 core channel continuous



Example: WLG 100 Q 0,1%

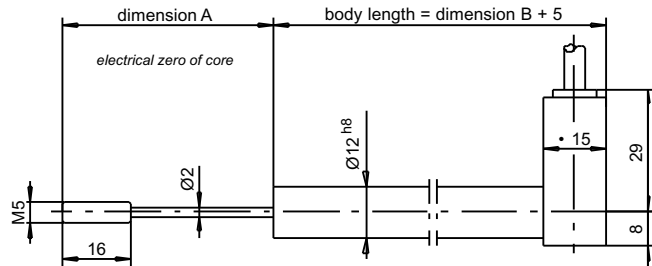

Radial connector interface

mating connector provided
 core channel continuous

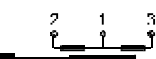

Example: WLG 100 R 0,5%

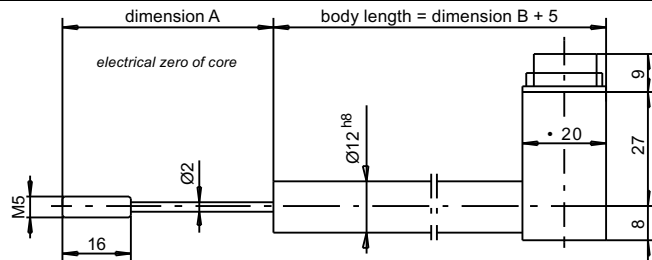

		WLG 10	WLG 20	WLG 50	WLG 100	WLG 150	WLG 200	WLG 250	WLG 300	WLG 400	WLG 500
Nominal stroke	mm	±5	±10	±25	±50	±75	±100	±125	±150	±200	±250
Maximum stroke***)	mm	20	30	60	120	170	220	270	320	420	516
Dimension A	mm	40	40	50	100	130	150	180	200	250	300
Dimension B	mm	80	100	145	245	355	455	565	675	875	1065
Transducer weight	g	40	60	85	120	150	200	230	280	350	440
Plunger weight	g	6	8	9	12	15	20	25	30	40	50
Nominal output signal	mV/V	80	80	80	80	80	80	80	80	80	80
Sensitivity	mV/V/mm	16	8	3,2	1,6	1,07	0,8	0,64	0,53	0,4	0,32
Excitation voltage		1 ... 5 Veff									
Excitation frequency		5 ... 10 kHz									
Linearity *)		±0.5% F.S.O.; option 0.25% and 0.1%									
Temperature coefficient of zero		±0.02% / 10K									
Temperature coefficient of span		±0.05% / 10K									
Operational temperature *)		-50°C ... +80°C option: up to 120°C									
Protection class (Din 40050)		IP 64									

*) select option when ordering

**) precision of calibration: ±3 mV/V; calibration also possible for other values

***) Not for inner end position with axial wire interface

WLG Series 10 ... 500 mm	Drawing 16.42.06
	Date 09/97 previous issue: 16.42.05