

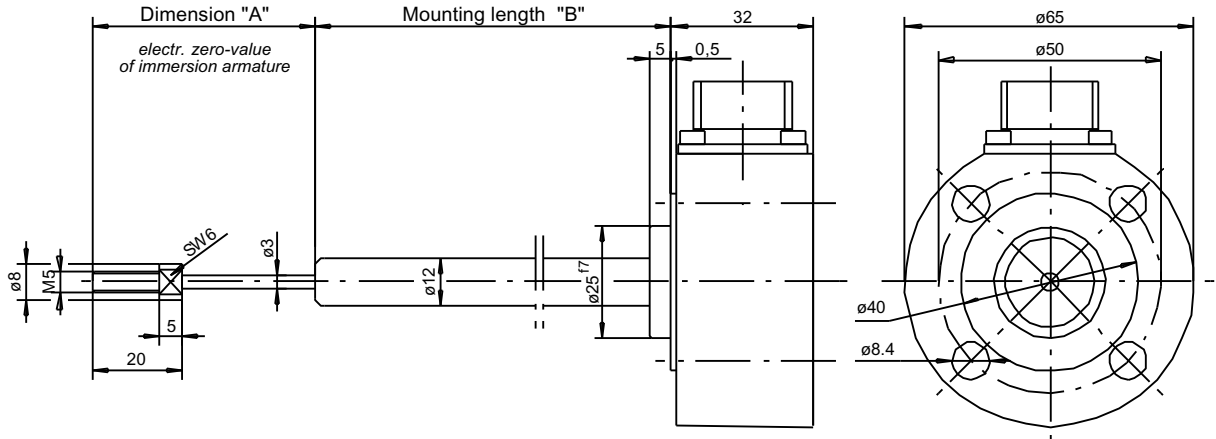

**Inductive Bulb Transducer**  
for cylinder mounting in hydraulics and pneumatics  
**DPL** (pressure proof up to 200 bar)

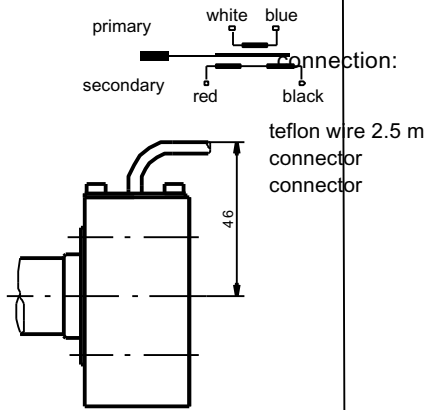

**radial wire interface**



**radial connector interface**

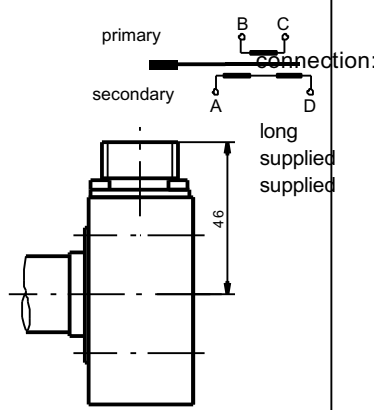

**axial connector interface**

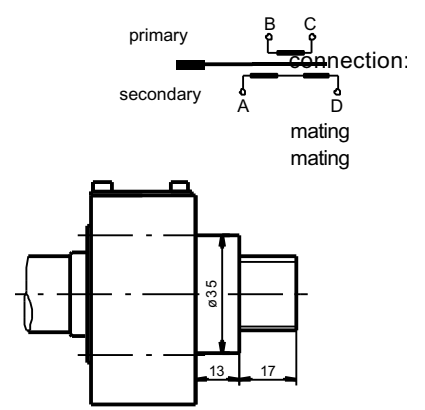

Example: DPL 150 Q 0.5%

Example: DPL 150 R 0.25%

Example:

		DPL 50	DPL 100	DPL150	DPL 200	DPL 250	DPL 300	DPL 400
Electrical stroke	mm	±25	±50	±75	±100	±125	±150	±200
Max. mechanical stroke	mm	55	105	160	210	260	320	420
Dimension A	mm	55	80	105	130	155	180	230
Mounting length B	mm	100	140	220	300	380	480	600
Transducer weight	g	730	750	830	870	900	950	950
Plunger weight	g	14	16	20	25	28	30	35
Excitation voltage	1 ... 5 Veff							
Excitation frequency *)	5 kHz option: 10 kHz							
Static resolution	virtually infinite							
Recommended amplifier	MBI 46.31							
Linearity *)	±0.5% F.S.O. option: ±0.25%							
Temperature coefficient of zero	±0.04% / 10K							
Temperature coefficient of span	±0.1% / 10K							
Pressure resistance	operating pressure 200 bar; test pressure 250 bar							
Operational temperature *)	-40°C ... +80°C, option: up to 120°C							
Protective system (DIN 40050)	IP 65							

\*) select option when ordering

	<b>DPL Series</b> <b>50 ... 400 mm</b>	<b>Drawing</b> <b>28.28.00</b>
		Date 04/97