

PEGASEM SRS

Slipring System for Car Wheels

For measurements at rotating parts located at the car axle the [PEGASEM Modular Mounting System](#) (MMS) is available with a 4 to 8 channel slip ring assembly in a waterproof package. The unit is easily and firmly attached to the lug nuts with magnetic holders or clamps. This allows fast fitting of harnesses for data acquisition sensors to the car wheel or axle. For temperature sensing with thermo-couples the SRS can be delivered with extension grade wires around the slip ring assembly and inside the harness protection tube. For extra high precision measurements the unit is available with a two channel spinning amplifier with cold junction compensation.

Features

- Quick mounting on the car wheel
- Robust and resists corrosion
- Waterproof
- 4, 6 or 8 slip ring channels
- Useful transportation case
- Optional thermo-couple preamplifier
- Cost effective solution

Applications

- Temperature measurement
- Torque measurement
- Vibration measurement

on rotating parts located at the car axle for

- Development
- Refinement
- Test
- Registration

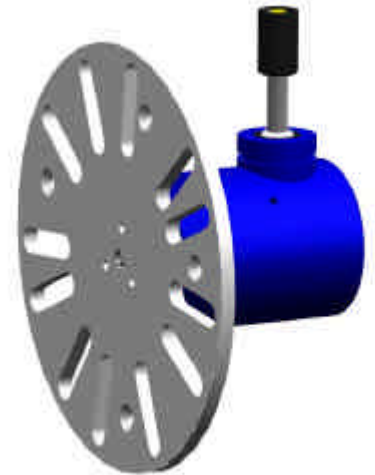

Technical Data:

Parameter	Value
Number Of Circuits	4, 6, 8
Current Capacity Per Circuit	500 mA
Temperature Range	- 40° ... + 120° C
RPM Rating	3000 RPM
Max. Contact Variation	0,1 Ohm
Input Connectors	User specific
Outputs	Gold plated Mini Snap Connectors
Package	Aluminium, black anodized
Dimensions (without slotted disk)	Appr. 90 x 65 mm (L x D)
Weight (without slotted disk)	Appr. 350 g
Mounting	Using the PEGASEM Modular Mounting System (MMS). Sold separately