

## Sub Miniature Pressure Transducer for High Temperature



### Features

- ➔ Available with 0,5-4,5Vdc output
- ➔ Designed for harsh environment
- ➔ Operating from -40 to +175°C
- ➔ Ultra light : < 5 grams

### Applications

- ➔ Automotive - on vehicle
- ➔ Oil & gas
- ➔ Energy / Nuclear
- ➔ Motorsport

Operating from -40 up to +175°C, the PHT100 series is dedicated to high temperature pressure measurements. With stainless steel wetted parts, it is compatible with most media, including corrosive fluids used in automotive, aerospace and energy industries. Equipped with the premium thin film technology developed by EFE, its performances and stability over wide temperature range are excellent. The PHT100 is available with unamplified output (mV/V), compensated in temperature to deliver the best accuracy. Amplified output (Vdc) is also standard, thanks to a high performance and ruggedized built-in electronic module.

## Technical specifications

Pressure ranges (FS)	-1/+4bar ; -1/+5bar ; 5bar ; 10bar ; 20bar ; 40bar ; 70bar ; 250bar ; -14.5/+60PSI ; -14.5/+70PSI ; 70PSI ; 150PSI ; 300PSI ; 500PSI ; 1000PSI ; 3000PSI
Type	Absolute ; Gage
Type (for ranges > 40 bar)	Sealed Gage
Safe overload	150% FS
Burst pressure	300% FS
Power supply	8 to 16Vdc
Consumption	< 10mA
Insulation	> 1000 MOhms under 50Vdc at ambient temperature
Output at -100%FS (only for $\pm$ range)	0.5Vdc
Output at 0%FS (except ranges $\pm$ )	0.5Vdc
Output at 100%FS	4.5Vdc
Zero and sensitivity settings tolerances	$\pm$ 50mV

## Technical Specifications

Non linearity and hysteresis combined	±0.25% FS typical (±0.35% FS max.)
Non repeatability	±0.02% FS typ.
Signal bandwidth	1000Hz @ -3dB Option : Special Adjustment up to 3000Hz @ -3dB
Compensated temperature range	-30 to +150°C Option : 0 to +175°C
Operating temperature range	-40 to +150°C (-40 to +175°C if optional compensation up to 175°C)
Combined thermal zero & sensitivity shifts	±0.02% FS/°C
Constant acceleration in linear vibrations	± 0.02% FS/g (frequency 20-2000Hz, 50g max.)
Mechanical shock	100g ½ sinus 1ms
Electrical protection	Not protected against polarity inversion
EMC protection	Compliant to EN61000
Electrical connection up to 150°C	AWG26, Viton Jacketed Shielded Cable Ø3mm, 4 wires
Electrical connection above 150°C	AWG26 Shielded Teflon Cable Ø3.4mm ±0.2, 5 wires
Mechanical connection	M5x0.8-6g male
Material(s) of wetted parts	Stainless Steel 316L ; Stainless Steel 17-4PH ; Stainless steel 15-5PH
Weight	< 5g without cable
Enclosure protection	IP65 for absolute & sealed gage version

## Codification

Sub Miniature Pressure Transducer for High Temperature	PHT10	7	S	10bar	G	05	08/1m	F	3	1	B	
Output Signal												
0.5-4.5Vdc unregulated power supply		7										
Material												
Stainless Steels			S									
Range												
Example				10bar								
Type												
Gage					G							
Sealed Gage					SG							
Mechanical connection												
M5x0.8-6g male						05						
Electrical connection												
AWG26, Viton Jacketed Shielded Cable Ø3mm, 4 wires							08/1m					
AWG26 Shielded Teflon Cable Ø3.4mm ±0.2, 5 wires							09/1m					
Compensated temperature range												
-30 to +150°C								F				
0 to +175°C								G				
Non linearity and hysteresis combined												
±0.25% FS typical (±0.35% FS max.)									3			
Combined thermal zero & sensitivity shifts												
±0.02% FS/°C										1		
Options												
Special Adjustment up to 3000Hz @ -3dB											B	

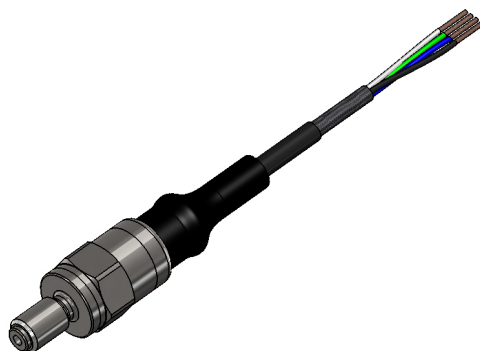
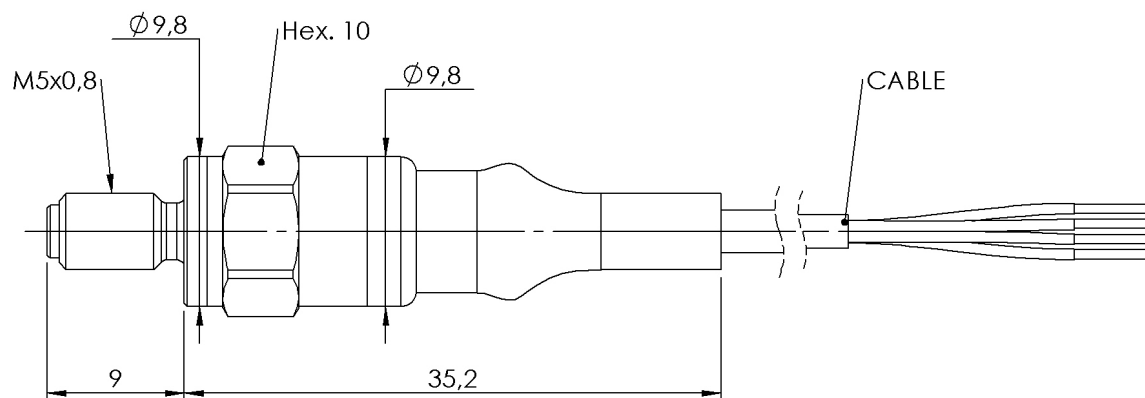

DIMENSIONS : mm

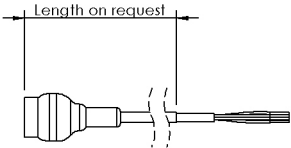
	#26 AWG, 4 CONDUCTOR SHIELDED VITON CABLE		
	VOLTAGE OUTPUT	CONDUCTOR	
	+ EXCITATION	RED	
	+ SIGNAL	GREEN / YELLOW	
	NC	WHITE	
	0 VOLT	BLUE / BLACK	
	SENSOR HOUSING	SHIELD	

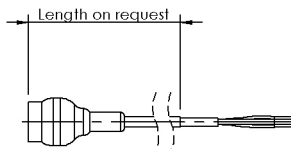
	5 CONDUCTOR TEFLON CABLE		
	VOLTAGE OUTPUT	CONDUCTOR	
	+ EXCITATION	RED	
	+ SIGNAL	GREEN	
	0 VOLT	BLACK	
	NC	WHITE	
	NC	BLUE	
	SENSOR HOUSING	SHIELD	

Agent :



E.F.E.

L'ESSOR FRANCAIS ELECTRONIQUE

16 Rue Porte a Bateaux - 27540 Ivry-la-Bataille - FRANCE

Tel : 33 (0)2 32 22 35 05 - Fax : 33 (0)2 32 36 93 08

[www.efe-sensor.com](http://www.efe-sensor.com) - [infos@efe-sensor.com](mailto:infos@efe-sensor.com)